

PG Range

(12yr Design Life in Float Service at 20°C)

Dimensions (mm)

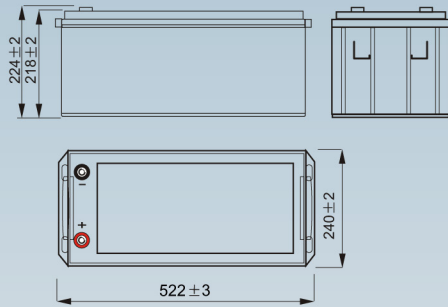

Standard terminal (mm)

T11 Threaded Insert 8mm STUD

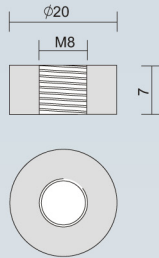

Physical Specification

Nominal Voltage		12V
Nominal Capacity		226.0 AH
Dimension	Length	522 ± 2 mm
	Width	240 + 2 mm
	Container Height	218 ± 2 mm
	Total Height (with terminal)	224 ± 2 mm
Weight		Approx 64.0kg
Standard Terminal		T11

PG12V220



Discharge Characteristics (25°C, 77°F)

Rated Capacity	20hr Rate(1.80V/cell)	220.0AH	Constant Voltage Charge	Cycle	Initial Charging Current Less than 56.5A Voltage 14.4V ~ 15.0V at 25°C (77°F)
	10hr Rate(1.80V/cell)	211.0AH			
Capacity Affected by Temperature	8hr Rate(1.75V/cell)	205.6AH	Standby	Recommended Charge Current less than 56.5A Voltage 13.5V ~ 13.8V at 15°C (77°F)	
	5hr Rate(1.75V/cell)	190.5AH			
	1hr Rate(1.60V/cell)	156.8AH			
Capacity Affected by Temperature	40°C (104°F)	103%	Standby	Recommended Charge Current less than 56.5A Voltage 13.5V ~ 13.8V at 15°C (77°F)	
	25°C (77°F)	100%			
	0°C (32°F)	86%			

Internal Resistance mΩ

2.8 mΩ

Constant Current Discharge Characteristics Unit: Amperes (20°C, 68°F)

F.V/Time	5mn	10mn	15mn	20mn	30mn	45mn	1H	2H	3H	4H	5H	6H	7H	8H	9H	10H	20H	24H	48H	72H	100H
1.90V	361.2	300.8	259.9	239.5	186.9	148.9	123.6	67.2	48.0	38.5	32.6	27.8	24.3	21.8	19.8	18.3	9.53	8.012	4.098	2.767	2.025
1.85V	421.5	345.6	304.7	268.7	212.2	163.5	135.1	73.4	52.0	42.0	35.1	30.4	26.6	23.8	21.6	20.0	10.41	8.750	4.478	3.053	2.230
1.80V	530.5	399.1	335.8	295.0	229.7	174.2	142.8	77.6	54.8	44.0	37.3	32.1	28.1	25.2	22.9	21.1	11.00	9.248	4.731	3.209	2.349
1.75V	568.5	440.0	360.2	315.4	242.4	182.0	147.2	79.2	56.1	45.4	38.1	32.8	28.7	25.7	23.4	21.6					
1.70V	630.8	473.1	384.5	330.0	250.2	187.9	150.5	81.0	57.2	46.3	38.9	33.5	29.3	26.3	23.8	22.1					
1.65V	693.1	506.2	404.0	341.7	258.0	190.8	154.7	82.5	58.4	47.0	39.5	34.0	29.8	26.6	24.1	22.4					
1.60V	751.5	528.6	414.7	349.5	261.9	192.7	156.8	84.0	59.9	47.5	40.1	34.4	30.3	27.1	24.5	22.7					

Constant Power Discharge Characteristics Unit: Watts (20°C, 68°F)

F.V/Time	5mn	10mn	15mn	20mn	30mn	45mn	1H	2H	3H	4H	5H	6H	7H	8H	9H	10H	20H	24H	48H	72H	100H
1.90V	4259.4	3575.4	3109.2	2884.8	2264.4	1812.0	1509.0	822.0	589.2	472.8	402.0	343.8	301.2	270.0	245.4	227.4	118.4	99.7	51.1	34.6	25.4
1.85V	4854.0	4020.0	3579.6	3187.8	2545.2	1977.6	1644.6	896.4	637.2	516.0	433.2	375.6	329.4	295.8	268.2	247.8	129.0	108.7	55.7	38.0	27.9
1.80V	6013.2	4564.8	3873.0	3431.4	2700.0	2071.8	1715.4	936.6	664.2	535.2	455.4	393.6	345.6	310.2	282.0	261.0	136.1	114.5	58.6	39.9	29.3
1.75V	6308.4	4952.4	4103.4	3634.2	2825.4	2153.4	1759.8	953.4	677.4	550.2	463.2	400.8	351.6	315.6	287.4	267.0					
1.70V	6808.8	5206.8	4320.6	3774.6	2900.4	2214.0	1794.0	972.0	690.6	561.0	473.4	409.2	358.8	322.2	293.4	271.8					
1.65V	7377.6	5520.6	4504.8	3879.0	2966.4	2228.4	1830.6	983.4	701.4	567.0	478.8	413.4	363.0	325.8	297.0	275.4					
1.60V	7817.4	5635.8	4549.2	3925.2	2991.0	2239.2	1846.2	997.2	715.8	571.2	484.2	417.0	368.4	330.6	301.2	279.6					



Power-Sonic Europe Limited
 3 Buckingham Square, Wickford, Essex, SS11 8YQ
 Tel: +44 (0)1268 560686 Fax: +44 (0)1268 560902
 sales@power-sonic.co.uk
 www.power-sonic.co.uk